

# Игольчатые вентили на высокое давление

## Особенности

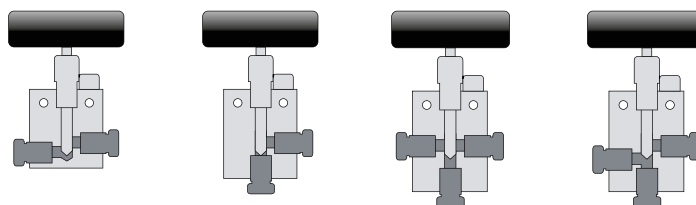

4 типа конфигураций вентилей (прямой, угловой и два типа трехходовых)  
 Препятствует заеданию благодаря невращающейся игле  
 Надежная конструкция уплотнения штока предотвращает негерметичность  
 Уплотнение седла "металл по металлу" с долгим сроком службы Используется 316-я нержавеющая сталь с высокой стойкостью к коррозии  
 Доступны стандартная ("Vee") и регулирующая ("Reg") игла для контроля расхода и полного запирания потока



|   | Давление                   | Наружный диаметр | Cv         | Тип иглы   | Конфигурация |            |                       |                       |             |  |  |  |
|---|----------------------------|------------------|------------|------------|--------------|------------|-----------------------|-----------------------|-------------|--|--|--|
|   |                            |                  |            |            | Прямой       | Угловой    | 3-х ходовой (1-й тип) | 3-х ходовой (2-й тип) |             |  |  |  |
| NVN:<br>NPT резьба<br>NVP:<br>PT резьба | 1034 бар<br>(15 000 psi)   | 1/8"             |            | Vee        | NVPVS02-S    | NVNVS02-S  | NVPS02-A              | NVNVS02-A             |             |  |  |  |
|   |                            |                  |            | Reg        | NVPRS02-S    | NVNRS02-S  | NVPRS02-A             | NVNRS02-A             |             |  |  |  |
|   |                            | 1/4"             |            | Vee        | NVPVS04-S    | NVNVS04-S  | NVPS04-A              | NVNVS04-A             |             |  |  |  |
|   |                            |                  |            | Reg        | NVPRS04-S    | NVNRS04-S  | NVPRS04-A             | NVNRS04-A             |             |  |  |  |
|   |                            | 3/8"             |            | Vee        | NVPVS06-S    | NVNVS06-S  | NVPS06-A              | NVNVS06-A             |             |  |  |  |
|   |                            |                  |            | Reg        | NVPRS06-S    | NVNRS06-S  | NVPRS06-A             | NVNRS06-A             |             |  |  |  |
|   | 689 бар<br>(10 000 psi)    | 1/2"             |            | Vee        | NVPVS08-S    | NVNVS08-S  | NVPS08-A              | NVNVS08-A             |             |  |  |  |
|   |                            |                  |            | Reg        | NVPRS08-S    | NVNRS08-S  | NVPRS08-A             | NVNRS08-A             |             |  |  |  |
|   |                            | 3/4"             |            | Vee        | NVPVS12-S    | NVNVS12-S  | NVPS12-A              | NVNVS12-A             |             |  |  |  |
|   |                            |                  |            | Reg        | NVPRS12-S    | NVNRS12-S  | NVPRS12-A             | NVNRS12-A             |             |  |  |  |
|   |                            | 1"               |            | Vee        | NVPVS16-S    | NVNVS16-S  | NVPS16-A              | NVNVS16-A             |             |  |  |  |
|   |                            |                  |            | Reg        | NVPRS16-S    | NVNRS16-S  | NVPRS16-A             | NVNRS16-A             |             |  |  |  |
| Низкое<br>давление                      | 1034 бар<br>(15 000 psi)   | 1/8"             | 0.12       | Vee        | NV15VS02-S   |            | NV15VS02-A            | NV15VS02-O            | NV15VS02-T  |  |  |  |
|   |                            |                  |            | Reg        | NV15RS02-S   |            | NV15RS02-A            | NV15RS02-O            | NV15RS02-T  |  |  |  |
|   |                            | 1/4"             | 0.20       | Vee        | NV15VS04-S   |            | NV15VS04-A            | NV15VS04-O            | NV15VS04-T  |  |  |  |
|   |                            |                  |            | Reg        | NV15RS04-S   |            | NV15RS04-A            | NV15RS04-O            | NV15RS04-T  |  |  |  |
|   | 3/8"                       | 0.20             | Vee        | NV15VS06-S |              | NV15VS06-A | NV15VS06-O            | NV15VS06-T            |             |  |  |  |
|   |                            |                  | Reg        | NV15RS06-S |              | NV15RS06-A | NV15RS06-O            | NV15RS06-T            |             |  |  |  |
| 689 бар<br>(10000 psi)                  | 1/2"                       | 1.62             | Vee        | NV10VS08-S |              | NV10VS08-A | NV10VS08-O            | NV10VS08-T            |             |  |  |  |
|   |                            |                  | Reg        | NV10RS08-S |              | NV10RS08-A | NV10RS08-O            | NV10RS08-T            |             |  |  |  |
| Среднее<br>давление                     | 1378 бар<br>(20 000 psi)   | 1/4"             | 0.31       | Vee        | NV20VS04-S   |            | NV20VS04-A            | NV20VS04-O            | NV20VS04-T  |  |  |  |
|   |                            |                  |            | Reg        | NV20RS04-S   |            | NV20RS04-A            | NV20RS04-O            | NV20RS04-T  |  |  |  |
|   |                            | 3/8"             | 0.75       | Vee        | NV20VS06-S   |            | NV20VS06-A            | NV20VS06-O            | NV20VS06-T  |  |  |  |
|   |                            |                  |            | Reg        | NV20RS06-S   |            | NV20RS06-A            | NV20RS06-O            | NV20RS06-T  |  |  |  |
|   |                            | 9/16"            | 1.30       | Vee        | NV20VS09-S   |            | NV20VS09-A            | NV20VS09-O            | NV20VS09-T  |  |  |  |
|   |                            |                  |            | Reg        | NV20RS09-S   |            | NV20RS09-A            | NV20RS09-O            | NV20RS09-T  |  |  |  |
|   | 3/4"                       | 2.50             | Vee        | NV20VS12-S |              | NV20VS12-A | NV20VS12-O            | NV20VS12-T            |             |  |  |  |
|   |                            |                  | Reg        | NV20RS12-S |              | NV20RS12-A | NV20RS12-O            | NV20RS12-T            |             |  |  |  |
| 1"                                      | 4.40                       | Vee              | NV20VS16-S |            | NV20VS16-A   | NV20VS16-O | NV20VS16-T            |                       |             |  |  |  |
|   |                            | Reg              | NV20RS16-S |            | NV20RS16-A   | NV20RS16-O | NV20RS16-T            |                       |             |  |  |  |
| Высокое<br>давление                     | 2068 бар<br>(30 000 psi)   | 1/8"             | 0.03       | Vee        | NV30VS02-S   |            | NV30VS02-A            | NV30VS02-O            | NV30VS02-T  |  |  |  |
|   |                            |                  |            | Reg        | NV30RS02-S   |            | NV30RS02-A            | NV30RS02-O            | NV30RS02-T  |  |  |  |
|   |                            | 1/4"             | 0.12       | Vee        | NV30VS04-S   |            | NV30VS04-A            | NV30VS04-O            | NV30VS04-T  |  |  |  |
|   |                            |                  |            | Reg        | NV30RS04-S   |            | NV30RS04-A            | NV30RS04-O            | NV30RS04-T  |  |  |  |
|   |                            | 3/8"             | 0.2        | Vee        | NV30VS06-S   |            | NV30VS06-A            | NV30VS06-O            | NV30VS06-T  |  |  |  |
|   |                            |                  |            | Reg        | NV30RS06-S   |            | NV30RS06-A            | NV30RS06-O            | NV30RS06-T  |  |  |  |
|   | 9/16"                      | 0.33             | Vee        | NV30VS09-S |              | NV30VS09-A | NV30VS09-O            | NV30VS09-T            |             |  |  |  |
|   |                            |                  | Reg        | NV30RS09-S |              | NV30RS09-A | NV30RS09-O            | NV30RS09-T            |             |  |  |  |
|   | 4136 бар<br>(60 000 psi)   | 1/4"             | 0.08       | Vee        | NV60VS04-S   |            | NV60VS04-A            | NV60VS04-O            | NV60VS04-T  |  |  |  |
|   |                            |                  |            | Reg        | NV60RS04-S   |            | NV60RS04-A            | NV60RS04-O            | NV60RS04-T  |  |  |  |
|   |                            | 3/8"             | 0.09       | Vee        | NV60VS06-S   |            | NV60VS06-A            | NV60VS06-O            | NV60VS06-T  |  |  |  |
|   |                            |                  |            | Reg        | NV60RS06-S   |            | NV60RS06-A            | NV60RS06-O            | NV60RS06-T  |  |  |  |
| 9/16"                                   |                            | 0.14             | Vee        | NV60VS09-S |              | NV60VS09-A | NV60VS09-O            | NV60VS09-T            |             |  |  |  |
|   |                            |                  | Reg        | NV60RS09-S |              | NV60RS09-A | NV60RS09-O            | NV60RS09-T            |             |  |  |  |
| Сверхвысокое<br>давление                | 6894 бар<br>(100 000 psi)  | 1/4"             | 0.09       | Vee        | NV100VS04-S  |            | NV100VS04-A           | NV100VS04-O           | NV100VS04-T |  |  |  |
|   |                            |                  |            | Reg        | NV100RS04-S  |            | NV100RS04-A           | NV100RS04-O           | NV100RS04-T |  |  |  |
|   | 10342 бар<br>(150 000 psi) | 3/8"             | 0.06       | Vee        | NV150VS06-S  |            | NV150VS06-A           | NV150VS06-O           | NV150VS06-T |  |  |  |
|   |                            |                  |            | Reg        | NV150RS06-S  |            | NV150RS06-A           | NV150RS06-O           | NV150RS06-T |  |  |  |

# Игольчатые вентили на высокое давление

## Конфигурации вентиляей

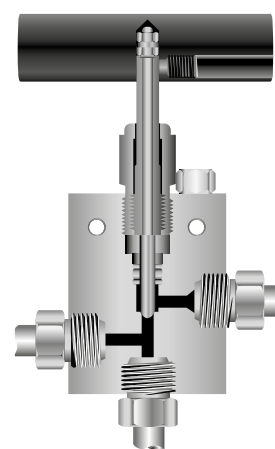
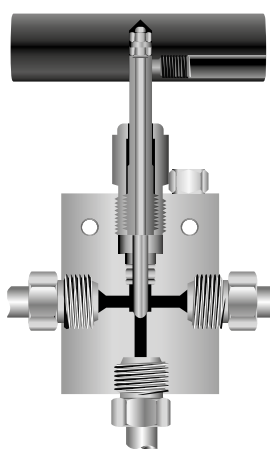
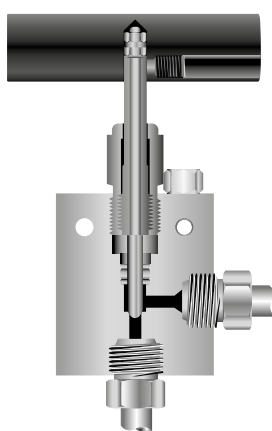
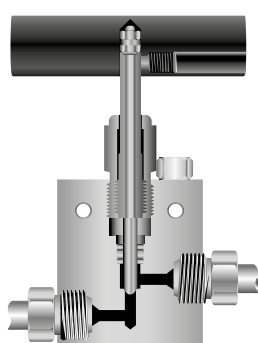

Прямой

Угловой

3-х ходовой (1-й тип)

3-х ходовой (2-й тип)

## Конструкция

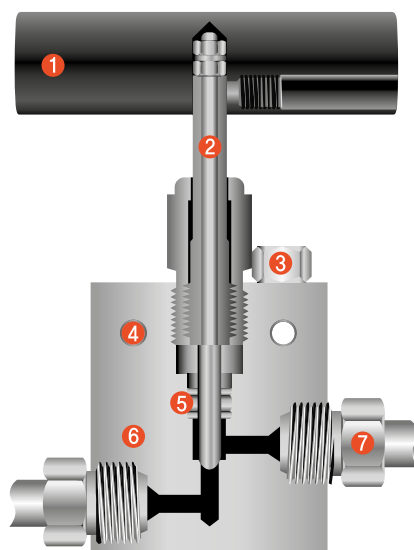

- 1 Рукоятка
- 2 Невращающаяся игла
- 3 Ограничитель крышки сальника
- 4 Отверстия для монтажа
- 5 Уплотнение штока
- 6 Корпус
- 7 Подсоединения

# Игольчатые вентили на высокое давление

## Прямой

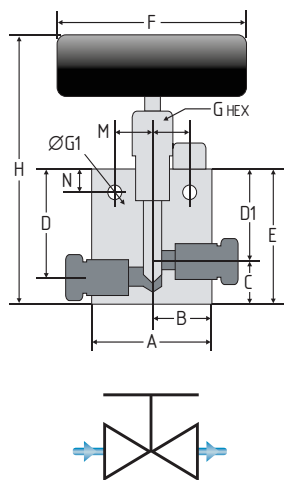

| Заказной код | Тип иглы | Рабочее давление          | Тип порта                | Наружный диаметр           | Cv     | Ду   | Размеры |      |      |      |      |     |      |     |     |        |       |       | Толщина |      |    |
|--------------|----------|---------------------------|--------------------------|----------------------------|--------|------|---------|------|------|------|------|-----|------|-----|-----|--------|-------|-------|---------|------|----|
|              |          |                           |                          |                            |        |      | A       | B    | C    | D    | D1   | E   | F    | G   | G1  | H      | M     | N     |         |      |    |
| NV15VS02-S   | Vee      | 1034 бар<br>(15 000 psi)  | H1502                    | 1/8"                       | 0.12   | 1.4  | 38      | 19   | 22   | 30   | 23   | 45  | 50   | 13  | 5   | 85.6   | 12.8  | 8     | 20      |      |    |
| NV15RS02-S   | Reg      |                           | H1504                    | 1/4"                       | 0.20   | 3.2  | 50      | 25   | 20   | 40   | 30   | 50  | 80   | 17  | 6.5 | 118.2  | 15.6  | 9.7   | 20      |      |    |
| NV15VS04-S   | Vee      |                           | H1506                    | 3/8"                       | 0.20   | 3.18 | 50      | 25   | 20.5 | 40.3 | 29.5 | 50  | 80   | 17  | 6.5 | 119    | 15.7  | 9.7   | 20      |      |    |
| NV15RS04-S   | Reg      |                           | H1008                    | 1/2"                       | 1.62   | 7.54 | 63      | 31.5 | 30.5 | 60.5 | 44.5 | 75  | 100  | 22  | 9   | 151.8  | 17.5  | 12.7  | 25      |      |    |
| NV10VS08-S   | Vee      |                           | 1378 бар<br>(20 000 psi) | H2004                      | 1/4"   | 0.31 | 3.18    | 50   | 25   | 20   | 40   | 30  | 50   | 80  | 17  | 6.5    | 118.2 | 15.7  | 9.7     | 20   |    |
| NV10RS08-S   | Reg      |                           |                          | H2006                      | 3/8"   | 0.75 | 5.5     | 50   | 25   | 20   | 40   | 30  | 50   | 80  | 17  | 6.5    | 117.5 | 15.7  | 9.7     | 20   |    |
| NV20VS04-S   | Vee      | H2009                     |                          | 9/16"                      | 1.30   | 7.9  | 63      | 31.5 | 29   | 60   | 44   | 73  | 100  | 22  | 8   | 145    | 17.5  | 12.7  | 30      |      |    |
| NV20RS04-S   | Reg      | H2012                     |                          | 3/4"                       | 2.50   | 11   | 76      | 38   | 38   | 76   | 57   | 95  | 253  | 30  | 10  | 177.8  | 23    | 15.8  | 35      |      |    |
| NV20VS06-S   | Vee      | H2016                     |                          | 1"                         | 4.40   | 14.3 | 105     | 52.5 | 49   | 96   | 71   | 120 | 260  | 41  | 14  | 217.8  | 31.75 | 28.5  | 45      |      |    |
| NV20RS06-S   | Reg      | 2068 бар<br>(30 000 psi)  |                          | H3002                      | 1/8"   | 0.03 | 1.6     | 38   | 19   | 22   | 30   | 23  | 45   | 50  | 13  | 5      | 82.2  | 12.75 | 8       | 20   |    |
| NV30VS02-S   | Vee      |                           | H3004                    | 1/4"                       | 0.12   | 2.4  | 50      | 25   | 21   | 43   | 33   | 54  | 80   | 20  | 6.5 | 121.36 | 17    | 9.7   | 25      |      |    |
| NV30RS02-S   | Reg      |                           | H3006                    | 3/8"                       | 0.2    | 3.2  | 50      | 25   | 24   | 43   | 33   | 57  | 80   | 20  | 6.5 | 124.4  | 17    | 9.7   | 25      |      |    |
| NV30VS04-S   | Vee      |                           | H3009                    | 9/16"                      | 0.33   | 3.2  | 67      | 33.5 | 29   | 43   | 33   | 62  | 80   | 20  | 6.5 | 130.3  | 17    | 9.7   | 38      |      |    |
| NV30RS04-S   | Reg      |                           | 4136 бар<br>(60 000 psi) | H6004                      | 1/4"   | 0.08 | 2       | 50   | 25   | 21   | 43   | 33  | 54   | 80  | 20  | 6.5    | 121.4 | 17    | 9.7     | 25   |    |
| NV30VS06-S   | Vee      |                           |                          | H6006                      | 3/8"   | 0.09 | 2       | 50   | 25   | 24   | 43   | 33  | 57   | 80  | 20  | 6.5    | 124.9 | 17    | 9.7     | 25   |    |
| NV30RS06-S   | Reg      | H6009                     |                          | 9/16"                      | 0.14   | 2    | 67      | 33.5 | 29   | 43   | 33   | 62  | 80   | 20  | 6.5 | 130    | 17    | 9.7   | 38      |      |    |
| NV30VS09-S   | Vee      | 6894 бар<br>(100 000 psi) |                          | H10004                     | 1/4"   | 0.09 | 2       | 67   | 33.5 | 28.5 | 49   | 35  | 63.5 | 100 | 24  | 6      | 132.4 | 20    | 9.7     | 38   |    |
| NV30RS09-S   | Reg      |                           |                          | 10342 бар<br>(150 000 psi) | H15006 | 3/8" | 0.06    | 1.59 | 90   | 45   | 30   | 42  | 34   | 64  | 100 | 24     | 7     | 135   | 19      | 12.7 | 38 |
| NV60VS04-S   | Vee      |                           |                          |                            |        |      |         |      |      |      |      |     |      |     |     |        |       |       |         |      |    |
| NV60RS04-S   | Reg      |                           |                          |                            |        |      |         |      |      |      |      |     |      |     |     |        |       |       |         |      |    |
| NV60VS06-S   | Vee      |                           |                          |                            |        |      |         |      |      |      |      |     |      |     |     |        |       |       |         |      |    |
| NV60RS06-S   | Reg      |                           |                          |                            |        |      |         |      |      |      |      |     |      |     |     |        |       |       |         |      |    |
| NV60VS09-S   | Vee      |                           |                          |                            |        |      |         |      |      |      |      |     |      |     |     |        |       |       |         |      |    |

## Угловой

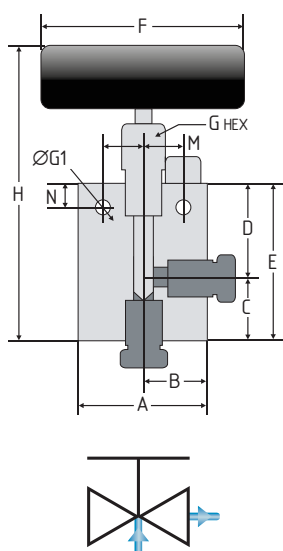

| Заказной код | Тип иглы | Рабочее давление          | Тип порта                  | Наружный диаметр         | Cv     | Ду   | Размеры |      |      |      |      |      |      |     |       |       |       |      | Толщина |    |
|--------------|----------|---------------------------|----------------------------|--------------------------|--------|------|---------|------|------|------|------|------|------|-----|-------|-------|-------|------|---------|----|
|              |          |                           |                            |                          |        |      | A       | B    | C    | D    | E    | F    | G    | G1  | H     | M     | N     |      |         |    |
| NV15VS02-A   | Vee      | 1034 бар<br>(15 000 psi)  | H1502                      | 1/8"                     | 0.12   | 1.4  | 38      | 19   | 22   | 23   | 45   | 50   | 13   | 5   | 82    | 12.8  | 8     | 20   |         |    |
| NV15RS02-A   | Reg      |                           | H1504                      | 1/4"                     | 0.20   | 3.2  | 50      | 25   | 32   | 30   | 62   | 80   | 17   | 6   | 130.2 | 15.7  | 9.7   | 20   |         |    |
| NV15VS04-A   | Vee      |                           | H1506                      | 3/8"                     | 0.20   | 3.2  | 50      | 25   | 32   | 30   | 62   | 80   | 17   | 6   | 131   | 15.7  | 9.7   | 20   |         |    |
| NV15RS04-A   | Reg      |                           | 1034 бар<br>(15 000 psi)   | H1008                    | 1/2"   | 1.62 | 8.5     | 63   | 31.5 | 41.5 | 44.5 | 86   | 100  | 22  | 9     | 162.8 | 17.6  | 12.7 | 25      |    |
| NV10VS08-A   | Vee      |                           |                            | H2004                    | 1/4"   | 0.31 | 3.2     | 50   | 25   | 32   | 30   | 62   | 80   | 17  | 6     | 130.2 | 15.7  | 9.7  | 20      |    |
| NV10RS08-A   | Reg      |                           |                            | H2006                    | 3/8"   | 0.75 | 5.5     | 50   | 25   | 32   | 30   | 62   | 80   | 17  | 6     | 129.5 | 15.7  | 9.7  | 20      |    |
| NV20VS04-A   | Vee      | 1378 бар<br>(20 000 psi)  |                            | H2009                    | 9/16"  | 1.30 | 7.9     | 63   | 31.5 | 41.5 | 44   | 85.5 | 100  | 22  | 8     | 156.6 | 17.5  | 12.7 | 30      |    |
| NV20RS04-A   | Reg      |                           |                            | H3002                    | 1/8"   | 0.03 | 1.6     | 38   | 19   | 22   | 23   | 45   | 50   | 13  | 5     | 86    | 12.75 | 8    | 20      |    |
| NV20VS06-A   | Vee      |                           |                            | H3004                    | 1/4"   | 0.12 | 2.4     | 50   | 25   | 27.5 | 33   | 60.5 | 80   | 20  | 6.5   | 126.4 | 17    | 9.7  | 25      |    |
| NV20RS06-A   | Reg      |                           | 2068 бар<br>(30 000 psi)   | H3006                    | 3/8"   | 0.2  | 3.2     | 50   | 25   | 33.5 | 33   | 66.5 | 80   | 20  | 6.5   | 133.9 | 17    | 9.7  | 25      |    |
| NV20VS09-A   | Vee      |                           |                            | H3009                    | 9/16"  | 0.33 | 3.2     | 67   | 33.5 | 34   | 33   | 67   | 80   | 20  | 6.5   | 133.8 | 17    | 9.7  | 38      |    |
| NV20RS09-A   | Reg      |                           |                            | 4136 бар<br>(60 000 psi) | H6004  | 1/4" | 0.08    | 2    | 50   | 25   | 27.5 | 33   | 60.5 | 80  | 20    | 6.5   | 127.9 | 17   | 9.7     | 25 |
| NV30VS02-A   | Vee      | H6006                     |                            |                          | 3/8"   | 0.09 | 2       | 50   | 25   | 33.5 | 33   | 66.5 | 80   | 20  | 6.5   | 134.4 | 17    | 9.7  | 25      |    |
| NV30RS02-A   | Reg      | H6009                     |                            |                          | 9/16"  | 0.14 | 2       | 67   | 33.5 | 34   | 33   | 67   | 80   | 20  | 6.5   | 134.4 | 17    | 9.7  | 38      |    |
| NV30VS04-A   | Vee      | 6894 бар<br>(100 000 psi) |                            |                          | H10004 | 1/4" | 0.09    | 1.59 | 67   | 33.5 | 30.5 | 30   | 63.5 | 100 | 24    | 6.5   | 130.2 | 20   | 9.7     | 38 |
| NV30RS04-A   | Reg      |                           | 10342 бар<br>(150 000 psi) |                          | H15006 | 3/8" | 0.06    | 1.59 | 90   | 45   | 32   | 30   | 62   | 100 | 24    | 7     | 130.2 | 19   | 12.7    | 38 |
| NV60VS04-A   | Vee      |                           |                            |                          |        |      |         |      |      |      |      |      |      |     |       |       |       |      |         |    |
| NV60RS04-A   | Reg      |                           |                            |                          |        |      |         |      |      |      |      |      |      |     |       |       |       |      |         |    |
| NV60VS06-A   | Vee      |                           |                            |                          |        |      |         |      |      |      |      |      |      |     |       |       |       |      |         |    |
| NV60RS06-A   | Reg      |                           |                            |                          |        |      |         |      |      |      |      |      |      |     |       |       |       |      |         |    |
| NV60VS09-A   | Vee      |                           |                            |                          |        |      |         |      |      |      |      |      |      |     |       |       |       |      |         |    |

# Игольчатые вентили на высокое давление

## 3-х ходовой (1-й тип)

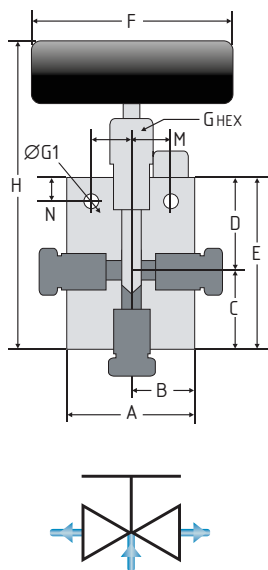

| Заказной код | Тип иглы | Рабочее давление | Тип порта    | Наружный диаметр | Cv   | Ду   | Размеры |      |      |      |      |      |    |     |       |       |      | Толщина |    |
|--------------|----------|------------------|--------------|------------------|------|------|---------|------|------|------|------|------|----|-----|-------|-------|------|---------|----|
|              |          |                  |              |                  |      |      | A       | B    | C    | D    | E    | F    | G  | G1  | H     | M     | N    |         |    |
| NV15VS02-O   | Vee      | 1034 бар         | H1502        | 1/8"             | 0.12 | 1.4  | 38      | 19   | 22   | 23   | 45   | 50   | 13 | 5   | 82    | 12.8  | 8    | 20      |    |
| NV15RS02-O   | Reg      | (15 000 psi)     |              |                  |      |      |         |      |      |      |      |      |    |     |       |       |      |         |    |
| NV15VS04-O   | Vee      | 1034 бар         | H1504        | 1/4"             | 0.20 | 3.2  | 50      | 25   | 32   | 30   | 62   | 80   | 17 | 6.5 | 130.2 | 15.6  | 9.7  | 20      |    |
| NV15RS04-O   | Reg      | (15 000 psi)     |              |                  |      |      |         |      |      |      |      |      |    |     |       |       |      |         |    |
| NV15VS06-O   | Vee      | 1034 бар         | H1506        | 3/8"             | 0.20 | 3.2  | 50      | 25   | 32   | 30   | 62   | 80   | 17 | 6.5 | 128.9 | 15.7  | 9.7  | 20      |    |
| NV15RS06-O   | Reg      | (15 000 psi)     |              |                  |      |      |         |      |      |      |      |      |    |     |       |       |      |         |    |
| NV10VS08-O   | Vee      | 689 бар          | H1008        | 1/2"             | 1.62 | 8.5  | 63      | 31.5 | 41.5 | 44.5 | 86   | 100  | 24 | 9   | 162.8 | 17.5  | 12.7 | 25      |    |
| NV10RS08-O   | Reg      | (10 000 psi)     |              |                  |      |      |         |      |      |      |      |      |    |     |       |       |      |         |    |
| NV20VS04-O   | Vee      | 1 378 бар        | H2004        | 1/4"             | 0.31 | 3.2  | 50      | 25   | 32   | 30   | 62   | 80   | 17 | 6   | 130.2 | 15.7  | 9.7  | 20      |    |
| NV20RS04-O   | Reg      |                  |              |                  |      |      |         |      |      |      |      |      |    |     |       |       |      |         |    |
| NV20VS06-O   | Vee      |                  |              | H2006            | 3/8" | 0.75 | 5.5     | 50   | 25   | 32   | 30   | 62   | 80 | 17  | 6.5   | 128.9 | 15.7 | 9.7     | 20 |
| NV20RS06-O   | Reg      | (20 000 psi)     |              |                  |      |      |         |      |      |      |      |      |    |     |       |       |      |         |    |
| NV20VS09-O   | Vee      | 1 378 бар        | H2009        | 9/16"            | 1.30 | 7.9  | 63      | 31.5 | 42   | 44   | 86   | 100  | 22 | 8   | 156.1 | 15.7  | 12.7 | 25      |    |
| NV20RS09-O   | Reg      |                  |              |                  |      |      |         |      |      |      |      |      |    |     |       |       |      |         |    |
| NV30VS02-O   | Vee      | 2 068 бар        | H3002        | 1/8"             | 0.03 | 1.6  | 38      | 19   | 22   | 23   | 45   | 50   | 13 | 5   | 82.2  | 12.8  | 8    | 20      |    |
| NV30RS02-O   | Reg      |                  |              |                  |      |      |         |      |      |      |      |      |    |     |       |       |      |         |    |
| NV30VS04-O   | Vee      |                  |              | H3004            | 1/4" | 0.12 | 2.4     | 50   | 25   | 27.5 | 33   | 60.5 | 80 | 20  | 6.5   | 126.4 | 17.2 | 9.7     | 25 |
| NV30RS04-O   | Reg      |                  | (30 000 psi) |                  |      |      |         |      |      |      |      |      |    |     |       |       |      |         |    |
| NV30VS06-O   | Vee      |                  |              | H3006            | 3/8" | 0.2  | 3.2     | 50   | 25   | 34   | 33   | 67   | 80 | 20  | 6.5   | 126.4 | 17.2 | 9.7     | 25 |
| NV30RS06-O   | Reg      |                  |              |                  |      |      |         |      |      |      |      |      |    |     |       |       |      |         |    |
| NV30VS09-O   | Vee      | 2 068 бар        | H3009        | 9/16"            | 0.33 | 3.2  | 67      | 33.5 | 38.5 | 33   | 71.5 | 80   | 20 | 6.5 | 130.3 | 17.2  | 9.7  | 38      |    |
| NV30RS09-O   | Reg      |                  |              |                  |      |      |         |      |      |      |      |      |    |     |       |       |      |         |    |
| NV60VS04-O   | Vee      |                  | 4 136 бар    | H6004            | 1/4" | 0.08 | 2       | 50   | 25   | 27.5 | 33   | 60.5 | 80 | 20  | 6.5   | 127.9 | 17   | 9.7     | 25 |
| NV60RS04-O   | Reg      | (60 000 psi)     |              |                  |      |      |         |      |      |      |      |      |    |     |       |       |      |         |    |
| NV60VS06-O   | Vee      |                  |              | H6006            | 3/8" | 0.09 | 2       | 50   | 25   | 34   | 33   | 67   | 80 | 20  | 6.5   | 135.2 | 17   | 9.7     | 25 |
| NV60RS06-O   | Reg      |                  |              |                  |      |      |         |      |      |      |      |      |    |     |       |       |      |         |    |
| NV60VS09-O   | Vee      | 4 136 бар        | H6009        | 9/16"            | 0.14 | 2    | 67      | 33.5 | 38.5 | 33   | 71.5 | 80   | 20 | 6.5 | 139.7 | 17    | 9.7  | 38      |    |
| NV60RS09-O   | Reg      |                  | (60 000 psi) |                  |      |      |         |      |      |      |      |      |    |     |       |       |      |         |    |
| NV100VS04-O  | Vee      | 6 894 бар        | H10004       | 1/4"             | 0.09 | 1.59 | 67      | 33.5 | 32   | 30   | 62   | 100  | 24 | 6.5 | 130.2 | 20    | 9.7  | 38      |    |
| NV100RS04-O  | Reg      | (100 000 psi)    |              |                  |      |      |         |      |      |      |      |      |    |     |       |       |      |         |    |
| NV150VS06-O  | Vee      | 1034 бар         | H15006       | 3/8"             | 0.06 | 1.59 | 90      | 45   | 32   | 30   | 62   | 100  | 24 | 7   | 130.2 | 19    | 12.7 | 38      |    |
| NV150RS06-O  | Reg      | (150 000 psi)    |              |                  |      |      |         |      |      |      |      |      |    |     |       |       |      |         |    |

## 3-х ходовой (2-й тип)

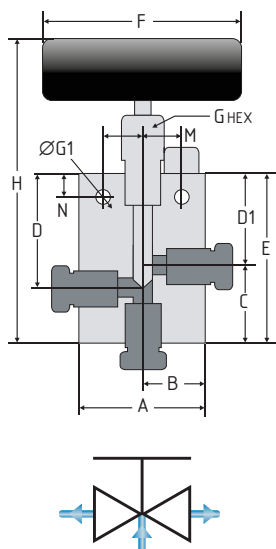

| Заказной код | Тип иглы | Рабочее давление | Тип порта    | Наружный диаметр | Cv   | Ду   | Размеры |      |      |      |      |      |      |    |     |       |       | Толщина |     |    |
|--------------|----------|------------------|--------------|------------------|------|------|---------|------|------|------|------|------|------|----|-----|-------|-------|---------|-----|----|
|              |          |                  |              |                  |      |      | A       | B    | C    | D    | D1   | E    | F    | G  | G1  | H     | M     |         | N   |    |
| NV15VS02-T   | Vee      | 1034 бар         | H1502        | 1/8"             | 0.12 | 1.4  | 38      | 19   | 22   | 30   | 23   | 45   | 50   | 13 | 5   | 82    | 12.8  | 8       | 20  |    |
| NV15RS02-T   | Reg      | (15 000 psi)     |              |                  |      |      |         |      |      |      |      |      |      |    |     |       |       |         |     |    |
| NV15VS04-T   | Vee      | 1034 бар         | H1504        | 1/4"             | 0.20 | 3.2  | 50      | 25   | 36.5 | 40   | 30   | 66.5 | 80   | 17 | 6.5 | 134.8 | 15.7  | 9.7     | 20  |    |
| NV15RS04-T   | Reg      | (15 000 psi)     |              |                  |      |      |         |      |      |      |      |      |      |    |     |       |       |         |     |    |
| NV15VS06-T   | Vee      | 1034 бар         | H1506        | 3/8"             | 0.20 | 3.2  | 50      | 25   | 36.5 | 41   | 30   | 66.5 | 80   | 17 | 6.5 | 133.3 | 15.7  | 9.7     | 20  |    |
| NV15RS06-T   | Reg      | (15 000 psi)     |              |                  |      |      |         |      |      |      |      |      |      |    |     |       |       |         |     |    |
| NV10VS08-T   | Vee      | 689 бар          | H1008        | 1/2"             | 1.62 | 8.5  | 63      | 31.5 | 47.5 | 60.5 | 44.5 | 92   | 100  | 24 | 9   | 168.8 | 17.5  | 12.7    | 25  |    |
| NV10RS08-T   | Reg      | (10 000 psi)     |              |                  |      |      |         |      |      |      |      |      |      |    |     |       |       |         |     |    |
| NV20VS04-T   | Vee      | 1378 бар         | H2004        | 1/4"             | 0.31 | 3.2  | 50      | 25   | 36.5 | 40   | 30   | 66.5 | 80   | 17 | 6.5 | 134.7 | 15.7  | 9.7     | 20  |    |
| NV20RS04-T   | Reg      |                  | (20 000 psi) |                  |      |      |         |      |      |      |      |      |      |    |     |       |       |         |     |    |
| NV20VS06-T   | Vee      |                  |              | H2006            | 3/8" | 0.75 | 5.5     | 50   | 25   | 36.5 | 40   | 30   | 66.5 | 80 | 17  | 6.5   | 133.3 | 15.7    | 9.7 | 20 |
| NV20RS06-T   | Reg      | (20 000 psi)     |              |                  |      |      |         |      |      |      |      |      |      |    |     |       |       |         |     |    |
| NV20VS09-T   | Vee      | 1378 бар         | H2009        | 9/16"            | 1.30 | 7.9  | 63      | 31.5 | 48   | 60   | 44   | 92   | 100  | 22 | 8   | 159.9 | 17.5  | 12.7    | 30  |    |
| NV20RS09-T   | Reg      |                  | (20 000 psi) |                  |      |      |         |      |      |      |      |      |      |    |     |       |       |         |     |    |
| NV30VS02-T   | Vee      | 2068 бар         | H3002        | 1/8"             | 0.03 | 1.6  | 38      | 19   | 22   | 30   | 23   | 45   | 50   | 13 | 5   | 87.2  | 12.8  | 8       | 20  |    |
| NV30RS02-T   | Reg      |                  | (30 000 psi) |                  |      |      |         |      |      |      |      |      |      |    |     |       |       |         |     |    |
| NV30VS04-T   | Vee      |                  |              | H3004            | 1/4" | 0.12 | 2.4     | 50   | 25   | 27.2 | 43   | 33   | 60.5 | 80 | 20  | 6.5   | 126.4 | 17.2    | 9.7 | 25 |
| NV30RS04-T   | Reg      |                  |              |                  |      |      |         |      |      |      |      |      |      |    |     |       |       |         |     |    |
| NV30VS06-T   | Vee      |                  |              | H3006            | 3/8" | 0.2  | 3.2     | 50   | 25   | 38.5 | 43   | 33   | 71.5 | 80 | 20  | 6.5   | 138.3 | 17      | 9.7 | 25 |
| NV30RS06-T   | Reg      |                  | (30 000 psi) |                  |      |      |         |      |      |      |      |      |      |    |     |       |       |         |     |    |
| NV30VS09-T   | Vee      | 2068 бар         | H3009        | 9/16"            | 0.33 | 3.2  | 67      | 33.5 | 44   | 43   | 33   | 77   | 80   | 20 | 6.5 | 145.3 | 17.2  | 9.7     | 38  |    |
| NV30RS09-T   | Reg      |                  |              |                  |      |      |         |      |      |      |      |      |      |    |     |       |       |         |     |    |
| NV60VS04-T   | Vee      |                  | 4136 бар     | H6004            | 1/4" | 0.08 | 2       | 50   | 25   | 27.2 | 43   | 33   | 60.5 | 80 | 20  | 6.5   | 127.9 | 17      | 9.7 | 25 |
| NV60RS04-T   | Reg      | (60 000 psi)     |              |                  |      |      |         |      |      |      |      |      |      |    |     |       |       |         |     |    |
| NV60VS06-T   | Vee      |                  |              | H6006            | 3/8" | 0.09 | 2       | 50   | 25   | 38.5 | 43   | 33   | 71.5 | 80 | 20  | 6.5   | 138.9 | 17      | 9.7 | 25 |
| NV60RS06-T   | Reg      | (60 000 psi)     |              |                  |      |      |         |      |      |      |      |      |      |    |     |       |       |         |     |    |
| NV60VS09-T   | Vee      | 4136 бар         | H6009        | 9/16"            | 0.14 | 2    | 67      | 33.5 | 44   | 43   | 33   | 77   | 80   | 20 | 6.5 | 144.4 | 17    | 9.7     | 38  |    |
| NV60RS09-T   | Reg      |                  | (60 000 psi) |                  |      |      |         |      |      |      |      |      |      |    |     |       |       |         |     |    |
| NV100VS04-T  | Vee      | 6894 бар         | H10004       | 1/4"             | 0.09 | 1.59 | 67      | 33.5 | 36.5 | 41   | 30   | 66.5 | 100  | 24 | 6.5 | 134.7 | 20    | 9.7     | 38  |    |
| NV100RS04-T  | Reg      | (100 000 psi)    |              |                  |      |      |         |      |      |      |      |      |      |    |     |       |       |         |     |    |
| NV150VS06-T  | Vee      | 10342 бар        | H15006       | 3/8"             | 0.06 | 1.59 | 90      | 45   | 36.5 | 41   | 30   | 66.5 | 100  | 24 | 7   | 134.7 | 19    | 12.7    | 38  |    |
| NV150RS06-T  | Reg      | (150 000 psi)    |              |                  |      |      |         |      |      |      |      |      |      |    |     |       |       |         |     |    |