

Штуцер с наружной резьбой (NPT коническая)

DMC-N

DMC-N.FLD.RU

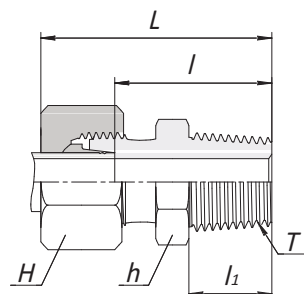

Серия	Заказной код	Наружный диаметр	H	h	L	l	l <sub>1</sub>	T N(NPT)	PN(бар)		
									Угл. сталь	SS316	Латунь
LL	DMC-04LL-01N.FLD.RU	4	10	11	28	18.5	9.9	1/8 - 27.0	100	100	
	DMC-06LL-01N.FLD.RU	6	12	11	28	16.5	9.9	1/8 - 27.0	100	100	63
	DMC-08LL-01N.FLD.RU	8	14	12	30	18.5	9.9	1/8 - 27.0	100	100	63
L	DMC-06L-01N.FLD.RU	6	14	12	32	17.0	9.9	1/8 - 27.0	315	315	200
	DMC-06L-02N.FLD.RU	6	14	17	38	23.0	14.2	1/4-18.0	315	315	200
	DMC-08L-02N.FLD.RU	8	17	17	38	23.0	14.2	1/4-18.0	315	315	200
	DMC-10L-02N.FLD.RU	10	19	17	39	24.0	14.2	1/4-18.0	315	315	200
	DMC-10L-03N.FLD.RU	10	19	19	40	25.0	14.2	3/8-18.0	315	315	
	DMC-12L-02N.FLD.RU	12	22	19	40	25.0	14.2	1/4-18.0	315	315	200
	DMC-12L-03N.FLD.RU	12	22	19	40	25.0	14.2	3/8-18.0	315	315	200
	DMC-12L-04N.FLD.RU	12	22	22	45	30.0	19.1	1/2-14.0	315	315	200
	DMC-15L-04N.FLD.RU	15	27	24	46	31.0	19.1	1/2-14.0	315	315	200
	DMC-18L-04N.FLD.RU	18	32	27	48	31.5	19.1	1/2-14.0	315	315	200
	DMC-22L-06N.FLD.RU	22	36	32	50	33.5	19.1	3/4-14.0	160	160	100
	DMC-28L-08N.FLD.RU	28	41	41	56	39.5	23.9	1 - 11.5	160	160	100
DMC-35L-10N.FLD.RU	35	50	46	62	40.5	23.9	1 1/4 - 11.5	160	160		
DMC-42L-12N.FLD.RU	42	60	55	65	42.0	25.4	1 1/2 - 11.5	160	160		
S	DMC-06S-02N.FLD.RU	6	17	17	43	28.0	14.2	1/4-18.0	630	630	400
	DMC-08S-02N.FLD.RU	8	19	17	43	28.0	14.2	1/4-18.0	630	630	400
	DMC-10S-02N.FLD.RU	10	22	19	44	27.5	14.2	1/4-18.0	630	630	
	DMC-10S-03N.FLD.RU	10	22	19	44	27.5	14.2	3/8-18.0	630	630	400
	DMC-12S-02N.FLD.RU	12	24	22	46	29.5	14.2	1/4-18.0	630	630	
	DMC-12S-03N.FLD.RU	12	24	22	46	29.5	14.2	3/8-18.0	630	630	400
	DMC-12S-04N.FLD.RU	12	24	22	51	34.5	19.1	1/2-14.0	630	630	400
	DMC-14S-04N.FLD.RU	14	27	24	54	36.0	19.1	1/2-14.0	630	630	400
	DMC-16S-04N.FLD.RU	16	30	27	54	35.5	19.1	1/2-14.0	400	400	250
	DMC-20S-06N.FLD.RU	20	36	32	59	37.5	19.1	3/4-14.0	400	400	250
	DMC-25S-08N.FLD.RU	25	46	41	69	45.0	23.9	1 - 11.5	400	400	
	DMC-30S-10N.FLD.RU	30	50	46	73	46.5	23.9	1 1/4 - 11.5	400	400	
DMC-38S-12N.FLD.RU	38	60	55	80	49.0	25.4	1 1/2 - 11.5	315	315		