

Штуцер с наружной резьбой (метрическая коническая)

DMC-MK

DMC-MK.FLD.RU

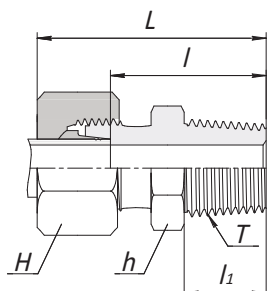

Штуцер с наружной резьбой (метрическая цилиндрическая)

DMC-M

DMC-M.FLD.RU

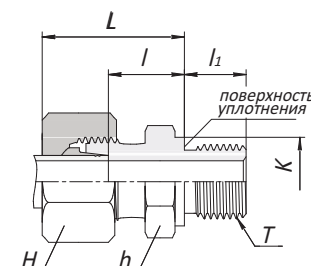

Серия	Заказной код	Наружный диаметр	H	h	K	L	l	l ₁	Т метрическая	PN(бар)		
										Угл. сталь	SS316	Латунь
LL	DMC-04LL-M6K.FLD.RU	4	10	9	-	26	16.0	8	M6×1 Keg	100		
	DMC-04LL-M8K.FLD.RU	4	10	10	-	26	16.0	8	M8×1 Keg	100	100	63
	DMC-06LL-M10K.FLD.RU	6	12	11	-	26	14.5	8	M10×1 Keg	100	100	63
	DMC-08LL-M10K.FLD.RU	8	14	12	-	28	16.5	8	M10×1 Keg	100	100	63
L	DMC-06L-M10.FLD.RU	6	14	14	14	23	8.5	8	M10×1	315	315	200
	DMC-08L-M12.FLD.RU	8	17	17	17	25	10.0	12	M12×1.5	315	315	200
	DMC-08L-M18.FLD.RU	8	17	24	23	26	11.5	12	M18×1.5	315	315	
	DMC-10L-M14.FLD.RU	10	19	19	19	26	11.0	12	M14×1.5	315	315	200
	DMC-10L-M16.FLD.RU	10	19	22	21	27	12.0	12	M16×1.5	315	315	
	DMC-10L-M18.FLD.RU	10	19	24	23	27	12.5	12	M18×1.5	315	315	
	DMC-10L-M22.FLD.RU	10	19	27	27	29	14.0	14	M22×1.5	315	315	
	DMC-12L-M14.FLD.RU	12	22	19	19	26	11.0	12	M14×1.5	315	315	
	DMC-12L-M16.FLD.RU	12	22	22	21	27	12.5	12	M16×1.5	315	315	
	DMC-12L-M18.FLD.RU	12	22	24	23	27	12.5	12	M18×1.5	315	315	
	DMC-12L-M22.FLD.RU	12	22	27	27	29	14.0	14	M22×1.5	315	315	
	DMC-15L-M16.FLD.RU	15	27	24	21	28	13.0	12	M16×1.5	250	250	
	DMC-15L-M18.FLD.RU	15	27	24	23	29	13.5	12	M18×1.5	250	250	100
	DMC-15L-M22.FLD.RU	15	27	27	27	30	15.0	14	M22×1.5	250	250	
	DMC-18L-M18.FLD.RU	18	32	27	23	30	14.0	12	M18×1.5	250	250	
	DMC-18L-M22.FLD.RU	18	32	27	27	31	14.5	14	M22×1.5	250	250	160
	DMC-22L-M22.FLD.RU	22	36	32	27	33	16.5	14	M22×1.5	160	160	
	DMC-22L-M26.FLD.RU	22	36	32	31	33	16.5	16	M26×1.5	160	160	100
DMC-28L-M33.FLD.RU	28	41	41	39	34	17.5	18	M33×2	160	160	100	
DMC-35L-M42.FLD.RU	35	50	50	49	39	17.5	20	M42×2	160	160	100	
DMC-42L-M48.FLD.RU	42	60	55	55	42	19.0	22	M48×2	160	160	100	
S	DMC-06S-M12.FLD.RU	6	17	17	17	28	13.0	12	M12×1.5	400	400	250
	DMC-08S-M14.FLD.RU	8	19	19	19	30	15.0	12	M14×1.5	400	400	250
	DMC-10S-M16.FLD.RU	10	22	22	21	31	15.0	12	M16×1.5	400	400	250
	DMC-12S-M18.FLD.RU	12	24	24	23	33	17.0	12	M18×1.5	400	400	250
	DMC-12S-M22.FLD.RU	12	24	27	27	34	17.5	14	M22×1.5	400	400	
	DMC-14S-M20.FLD.RU	14	27	27	25	37	19.0	14	M20×1.5	400	400	250
	DMC-16S-M18.FLD.RU	16	30	27	23	36	18.0	12	M18×1.5	400	400	
	DMC-16S-M22.FLD.RU	16	30	27	27	37	18.5	14	M22×1.5	400	400	250
	DMC-20S-M27.FLD.RU	20	36	32	32	42	20.5	16	M27×2	400	400	250
	DMC-25S-M33.FLD.RU	25	46	41	39	47	23.0	18	M33×2	250	250	160
	DMC-30S-M42.FLD.RU	30	50	50	49	50	23.5	20	M42×2	160	160	100
	DMC-38S-M48.FLD.RU	38	60	55	55	57	26.0	22	M48×2	160	160	100