

Адаптер угловой

DLA

DLA.FLD.RU

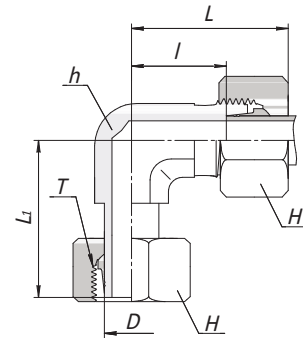

| Серия | Заказной код | Наружный диаметр | D | H | h | L | L ₁ | I | T | PN(бар) | | |
|----------------|----------------|------------------|----|----|----|------|----------------|-------|---------|------------|-------|--------|
| | | | | | | | | | | Угл. сталь | SS316 | Латунь |
| L | DLA-08L.FLD.RU | 8 | 8 | 17 | 12 | 29 | 27.5 | 14.0 | M14×1.5 | 315 | 315 | 200 |
| | DLA-10L.FLD.RU | 10 | 10 | 19 | 14 | 30 | 29.0 | 15.0 | M16×1.5 | 315 | 315 | 200 |
| | DLA-12L.FLD.RU | 12 | 12 | 22 | 17 | 32 | 29.5 | 17.0 | M18×1.5 | 315 | 315 | 200 |
| | DLA-15L.FLD.RU | 15 | 15 | 27 | 19 | 36 | 32.5 | 21.0 | M22×1.5 | 315 | 315 | 200 |
| | DLA-18L.FLD.RU | 18 | 18 | 32 | 24 | 40 | 35.5 | 23.5 | M26×1.5 | 315 | 315 | 200 |
| | DLA-22L.FLD.RU | 22 | 22 | 36 | 27 | 44 | 38.5 | 27.5 | M30×2 | 160 | 160 | 100 |
| | DLA-28L.FLD.RU | 28 | 28 | 41 | 36 | 47 | 41.5 | 30.5 | M36×2 | 160 | 160 | 100 |
| | DLA-35L.FLD.RU | 35 | 35 | 50 | 41 | 56 | 51.0 | 34.5 | M45×2 | 160 | 160 | 100 |
| DLA-42L.FLD.RU | 42 | 42 | 60 | 50 | 63 | 56.0 | 40.0 | M52×2 | 160 | 160 | 100 | |
| S | DLA-06S.FLD.RU | 6 | 6 | 17 | 12 | 31 | 27.0 | 16.0 | M14×1.5 | 630 | 630 | 400 |
| | DLA-08S.FLD.RU | 8 | 8 | 19 | 14 | 32 | 27.5 | 17.0 | M16×1.5 | 630 | 630 | 400 |
| | DLA-10S.FLD.RU | 10 | 10 | 22 | 17 | 34 | 30.0 | 17.5 | M18×1.5 | 630 | 630 | 400 |
| | DLA-12S.FLD.RU | 12 | 12 | 24 | 17 | 38 | 31.0 | 21.5 | M20×1.5 | 630 | 630 | 400 |
| | DLA-14S.FLD.RU | 14 | 14 | 27 | 19 | 40 | 35.0 | 22.0 | M22×1.5 | 400 | 400 | 250 |
| | DLA-16S.FLD.RU | 16 | 16 | 30 | 24 | 43 | 36.5 | 24.5 | M24×1.5 | 400 | 400 | 250 |
| | DLA-20S.FLD.RU | 20 | 20 | 36 | 27 | 48 | 44.5 | 26.5 | M30×2 | 400 | 400 | 250 |
| | DLA-25S.FLD.RU | 25 | 25 | 46 | 36 | 54 | 50.0 | 30.0 | M36×2 | 400 | 400 | 250 |
| DLA-30S.FLD.RU | 30 | 30 | 50 | 41 | 62 | 55.0 | 35.5 | M42×2 | 400 | 400 | 250 | |
| DLA-38S.FLD.RU | 38 | 38 | 60 | 50 | 72 | 63.0 | 41.0 | M52×2 | 315 | 315 | 200 | |