

Штуцер угловой наружной конической резьбой NPT (или BSPT)

CLMA

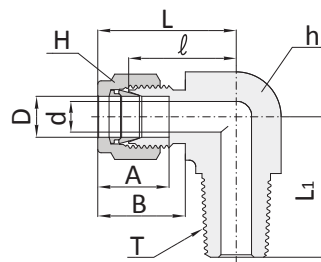

Соединение дюймовых трубок с внутренней конической резьбой

Заказной номер	Наружный диаметр трубы D		NPT«N» (или BSPT«R»)	d Min.	Размер под ключ				A	B	I	L	L ₁
	дюймы	мм			h		H						
					дюймы	мм	дюймы	мм					
CLMA-1-1N(R)	1/16	1.58	1/16	1.27	7/16	11.11	5/16	7.93	8.63	10.92	15.24	19.05	17.78
CLMA-1-2N(R)	1/16	1.58	1/8	1.27	7/16	11.11	5/16	7.93	8.63	10.92	15.24	19.05	17.78
CLMA-2-2N(R)	1/8	3.17	1/8	2.28	1/2	12.70	7/16	11.11	12.70	15.24	18.30	24.91	18.90
CLMA-2-4N(R)	1/8	3.17	1/4	2.28	1/2	12.70	7/16	11.11	12.70	15.24	18.30	24.91	23.36
CLMA-3-2N(R)	3/16	4.76	1/8	3.04	1/2	12.70	1/2	12.70	13.71	16.00	18.79	25.40	18.79
CLMA-3-4N(R)	3/16	4.76	1/4	3.04	1/2	12.70	1/2	12.70	13.71	16.00	18.79	25.40	23.36
CLMA-4-1N(R)	1/4	6.35	1/16	3.04	1/2	12.70	9/16	14.28	15.24	17.78	19.55	26.90	18.79
CLMA-4-2N(R)	1/4	6.35	1/8	4.82	1/2	12.70	9/16	14.28	15.24	17.78	19.10	26.47	19.10
CLMA-4-4N(R)	1/4	6.35	1/4	4.82	1/2	12.70	9/16	14.28	15.24	17.78	19.81	27.18	23.87
CLMA-4-6N(R)	1/4	6.35	3/8	4.82	11/16	17.346	9/16	14.28	15.24	17.78	22.35	29.71	28.40
CLMA-4-8N(R)	1/4	6.35	1/2	4.82	13/16	20.63	9/16	14.28	15.24	17.78	24.60	31.97	33.00
CLMA-5-2N(R)	5/16	7.93	1/8	4.82	9/16	14.28	5/8	15.87	16.25	18.54	21.33	28.70	19.81
CLMA-5-4N(R)	5/16	7.93	1/4	6.35	9/16	14.28	5/8	15.87	16.25	18.54	22.40	29.77	24.50
CLMA-5-6N(R)	5/16	7.93	3/8	6.35	11/16	17.46	5/8	15.87	16.25	18.54	23.11	30.48	28.40
CLMA-6-2N(R)	3/8	9.52	1/8	4.82	5/8	15.87	11/16	17.46	16.76	19.30	23.11	30.48	20.80
CLMA-6-4N(R)	3/8	9.52	1/4	7.11	5/8	15.87	11/16	17.46	16.76	19.30	23.11	30.48	25.40
CLMA-6-6N(R)	3/8	9.52	3/8	7.11	11/16	17.46	11/16	17.46	16.76	19.30	23.87	31.24	28.44
CLMA-6-8N(R)	3/8	9.52	1/2	7.11	13/16	20.63	11/16	17.46	16.76	19.30	23.80	31.42	33.02
CLMA-6-12N(R)	3/8	9.52	3/4	7.11	1-1/16	26.98	11/16	17.46	16.76	19.30	29.71	37.08	36.83
CLMA-8-4N(R)	1/2	12.70	1/4	7.11	13/16	20.63	7/8	22.22	22.86	21.84	25.90	36.06	28.30
CLMA-8-6N(R)	1/2	12.70	3/8	9.65	13/16	20.63	7/8	22.22	22.86	21.84	25.90	36.06	28.30
CLMA-8-8N(R)	1/2	12.70	1/2	10.41	13/16	20.63	7/8	22.22	22.86	21.84	25.90	36.06	33.02
CLMA-8-12N(R)	1/2	12.70	3/4	10.41	1-1/16	26.38	7/8	22.22	22.86	21.84	29.71	39.87	36.29
CLMA-10-6N(R)	5/8	15.87	3/8	9.65	15/16	23.80	1	25.40	24.92	21.84	27.90	37.06	30.20
CLMA-10-8N(R)	5/8	15.87	1/2	11.93	15/16	23.80	1	25.40	24.92	21.84	27.90	37.06	35.00
CLMA-10-12N(R)	5/8	15.87	3/4	12.70	1-1/16	26.98	1	25.40	24.92	21.84	29.71	39.87	36.29
CLMA-12-8N(R)	3/4	19.05	1/2	11.93	1-1/16	26.98	1-1/8	28.57	24.92	21.84	29.71	39.87	36.29
CLMA-12-12N(R)	3/4	19.05	3/4	15.74	1-1/16	26.98	1-1/8	28.57	24.92	21.84	29.71	39.87	36.29
CLMA-14-12N(R)	7/8	22.22	3/4	15.74	1-3/16	30.00	1-1/4	31.75	25.90	21.84	34.54	44.70	41.65
CLMA-16-12N(R)	1	25.40	3/4	15.74	1-3/8	34.92	1-1/2	38.10	31.24	26.41	36.83	49.02	42.20
CLMA-16-16N(R)	1	25.40	1	22.35	1-3/8	34.92	1-1/2	38.10	31.24	26.41	36.83	49.02	46.70
CLMA-20-20N(R)	1-1/4	31.75	1-1/4	27.68	1-11/16	42.86	1-7/8	47.62	41.14	38.86	47.40	66.54	47.75
CLMA-24-24N(R)	1-1/2	38.10	1-1/2	34.03	2	50.80	2-1/4	57.15	50.03	45.21	50.80	77.97	60.45
CLMA-32-32N(R)	2	50.80	2	45.97	2-3/4	69.85	3	76.20	67.56	62.73	69.80	107.18	70.61

Внимание: Hy-Lok также производит позиционируемые фитинги (стр.48).

Все размеры указаны в миллиметрах, за исключением отдельно обозначенных.

Штуцер угловой наружной конической резьбой NPT (или BSPT)

CLMA

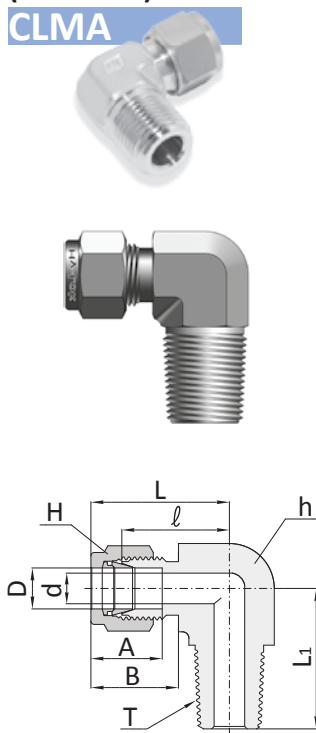

Соединение метрических трубок с внутренней конической резьбой

Заказной номер	Наружный диаметр трубы D	NPT«N» (или BSPT«R»)	d Min.	Размер под ключ		A	B	I	L	L ₁
				h	H					
CLMA-3M-2N(R)	3	1/8	2.4	12.7	12	12.9	15.3	17.0	23.6	17.8
CLMA-3M-4N(R)	3	1/4	2.4	12.7	12	12.9	15.3	18.0	24.6	23.4
CLMA-4M-2N(R)	4	1/8	2.4	12.7	12	13.7	16.1	18.8	25.4	18.8
CLMA-4M-4N(R)	4	1/4	2.4	12.7	12	13.7	16.1	18.8	25.4	23.4
CLMA-6M-2N(R)	6	1/8	4.8	12.7	14	15.3	17.7	19.6	27.0	18.8
CLMA-6M-4N(R)	6	1/4	4.8	12.7	14	15.3	17.7	19.6	27.0	23.4
CLMA-6M-6N(R)	6	3/8	4.8	17.5	14	15.3	17.7	22.4	29.8	26.2
CLMA-6M-8N(R)	6	1/2	4.8	20.6	14	15.3	17.7	24.4	31.8	33.0
CLMA-8M-2N(R)	8	1/8	4.8	14.3	16	16.2	18.6	21.3	28.8	19.8
CLMA-8M-4N(R)	8	1/4	6.4	14.3	16	16.2	18.6	21.3	28.8	24.4
CLMA-8M-6N(R)	8	3/8	6.4	17.5	16	16.2	18.6	23.9	31.4	28.5
CLMA-8M-8N(R)	8	1/2	6.4	20.6	16	16.2	18.6	25.1	32.6	33.0
CLMA-10M-2N(R)	10	1/8	4.8	17.5	19	17.2	19.5	23.9	31.5	23.6
CLMA-10M-4N(R)	10	1/4	7.1	17.5	19	17.2	19.5	23.9	31.5	26.2
CLMA-10M-6N(R)	10	3/8	7.9	17.5	19	17.2	19.5	23.9	31.5	26.2
CLMA-10M-8N(R)	10	1/2	7.9	20.6	19	17.2	19.5	25.9	33.5	33.0
CLMA-12M-2N(R)	12	1/8	4.8	20.6	22	22.8	22.0	25.9	36.0	23.6
CLMA-12M-4N(R)	12	1/4	7.1	20.6	22	22.8	22.0	25.9	36.0	26.2
CLMA-12M-6N(R)	12	3/8	9.5	20.6	22	22.8	22.0	25.9	36.0	26.2
CLMA-12M-8N(R)	12	1/2	9.5	20.6	22	22.8	22.0	25.9	36.0	33.0
CLMA-12M-12N(R)	12	3/4	9.5	27.0	22	22.8	22.0	29.7	39.8	36.8
CLMA-14M-8N(R)	14	1/2	11.1	24	25	24.4	22	27.9	38	35.1
CLMA-16M-6N(R)	16	3/8	9.5	23.8	25	24.4	22.0	27.9	38.0	30.2
CLMA-16M-8N(R)	16	1/2	11.9	23.8	25	24.4	22.0	27.9	38.0	35.1
CLMA-16M-12N(R)	16	3/4	12.7	27.0	25	24.4	22.0	29.7	39.8	36.8
CLMA-18M-8N(R)	18	1/2	11.9	27.0	30	24.4	22.0	29.7	39.8	36.8
CLMA-18M-12N(R)	18	3/4	15.1	27.0	30	24.4	22.0	29.7	39.8	36.8
CLMA-20M-8N(R)	20	1/2	11.9	34.9	32	26.0	22.0	34.5	44.6	41.7
CLMA-20M-12N(R)	20	3/4	15.9	30.0	32	26.0	22.0	34.5	44.6	41.7
CLMA-22M-12N(R)	22	3/4	15.9	30.0	32	26.0	22.0	34.5	44.6	41.7
CLMA-22M-16N(R)	22	1	18.3	34.9	32	26.0	22.0	34.5	44.6	46.5
CLMA-25M-12N(R)	25	3/4	15.9	34.9	38	31.3	26.5	36.8	49.1	41.7
CLMA-25M-16N(R)	25	1	21.8	34.9	38	31.3	26.5	36.8	49.1	46.5